



# LAKE CREEK GREENWAY NEWSLETTER



## March 2019

**WILDLIFE SURVEYS BEGINNING** – Our recent grant from the Westwood Magnolia Parkway Improvement District (WMPID) has allowed us to purchase game and security cameras which will gradually be installed around the Lake Creek Preserve. As you might expect the initial cameras picked up deer, coyote, racoon and feral hogs, but we were surprised when a bobcat showed up in these pictures from December 28 and January 24. The camera by the pond also picked up a River Otter who seems to have taken up residence there. We are looking for a high school/college student interested in doing a more rigorous study of wildlife in the preserve including their distribution, frequency and general habits and have a small grant to support a modest amount of equipment and materials.



### EFFECTS OF FLOODING IN THE PRESERVE

Since mid-2015 there have been 15 rain events that caused Lake Creek to rise 15 feet or more (Harvey rose 29.5 feet at the Fish Creek Bridge). Four of those events occurred in the past four months. Aside from logs and debris covering the trail, damage to the boardwalks, platforms and kiosk has been minimal. This speaks well for the Scouts who constructed these amenities.

Now that the trees are beginning to leaf out, we expect them to accelerate the drying of the trail as they begin to transpire. At this time the sandy soils in northern parts of both trails are fairly dry, but the clay soil to the south may take a couple more weeks to dry out.

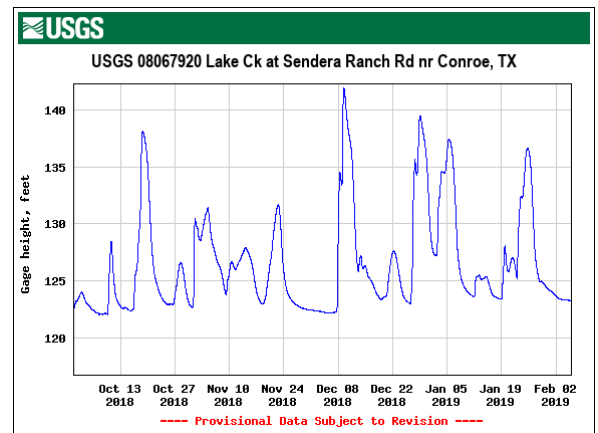

### POND TEACHING AREA NOW AVAILABLE FOR NATURE PROGRAMS

A portion of Michael Gillogly's Eagle project included adding two more benches to the pond program area which is now ready for small group nature presentations which we plan to begin offering later this year. We expect to have one more bench ready to install in this area during the next trail maintenance day.

Michael has also added additional benches along the trails to improve the outdoor experience.



## **TWO COMMUNITY EDUCATIONAL/FUN EVENTS SCHEDULED**

Our WMPID grant also includes money for community programs to expose residents to the educational and recreational opportunities and services provided by the Lake Creek bottomlands and floodplains. We are planning our first two event for April 13 and October 5 of this year.

On Saturday, April 13 we will hold an event focused on the creatures, features and water resources of the Lake Creek and surrounding watersheds. In addition to educational displays and demonstrations including landscaping and local wildlife and we plan to have hands on activities involving fishing instruction, animals, water testing and evaluating water quality using aquatic insects. We have also confirmed that the Lone Star Groundwater District will have their educational trailer there. We have reserved the new Christine-Allen Park for the event. As it is directly adjacent to the Lake Creek Preserve, we also hope to have tours of the preserve (weather and trail condition permitting). **See Flyer following newsletter**

On Saturday, October 5, together with Woodforest, we plan to hold a Harvest festival to celebrate farming, agriculture and fruits of the soil. Although early in the planning process. Exhibits may include demonstrations on soils and soil organisms, a barnyard petting zoo, major crops of Texas, pollinator gardens etc.

## **PENDING PROJECTS**

48 Eagle projects have nearly completed the planned infrastructure for the preserve. Except for several of the following projects most of the remaining work will involve maintenance and/or enhancements for wildlife.

1. Construct last boardwalk through a low area on the blue trail. - Eagle Project
2. Add crushed basalt to NE entrance and low portions of trail connecting to Christine- Allen Park. - Eagle Project
3. Construct informational Kiosk in the NE corner the preserve. – Eagle Project
4. Construct and install Wood Duck nesting boxes in wet area of preserve. – Eagle Project
5. Construct and install bird feeders near observation decks. – Eagle Project
6. Seal leakage and stabilize bank on north side of drainage culvert along entrance road.- Eagle Project
7. Prepare Monarch feeding locations in the preserve using native milkweed – Board project

## **NEXT TRAIL MAINTENANCE DAY SCHEDULED FOR SATURDAY MARCH 30**

We anticipate that the trail will be sufficiently dry by the end of the month to do our spring clean up and trimming. There is likely to be a bit more work to level the portions of the trail that were especially muddy, but except for installing the last bench at the pond most of the rest of the work should involve mowing, trimming and removing tripping hazards. Please let either Glenn Buckley [glenn@lakecreektx.org](mailto:glenn@lakecreektx.org) or Melissa Hendricks [sniffies@aol.com](mailto:sniffies@aol.com) know if you are available to help.

# **EVENT FLYER FOLLOWS**



# **WATER RESOURCES DAY**



**10am to 3pm on Saturday April 13**

Join us at the Christine-Allen Park and Montgomery County Lake Creek Preserve to learn about our water resources and services and recreational opportunities provided by our geology, bottomland forests and associated streams and wetlands.

## **EDUCATIONAL**

- Lone Star Groundwater District educational trailer.
  - Native landscaping & butterfly gardens.
- Information about the Lake Creek watershed.
  - Rainfall simulator
- Outdoor recreational opportunities available.

## **FUN FOR YOUTH**

- Fishing Activities
- Water Testing/Quality Evaluation
- Aquatic Life Discovery Activity
  - Local Wildlife

## **MAP ON BACK**



Programs supported by:  
Lake Creek Greenway Partnership  
Westwood Magnolia Parkway Improvement District



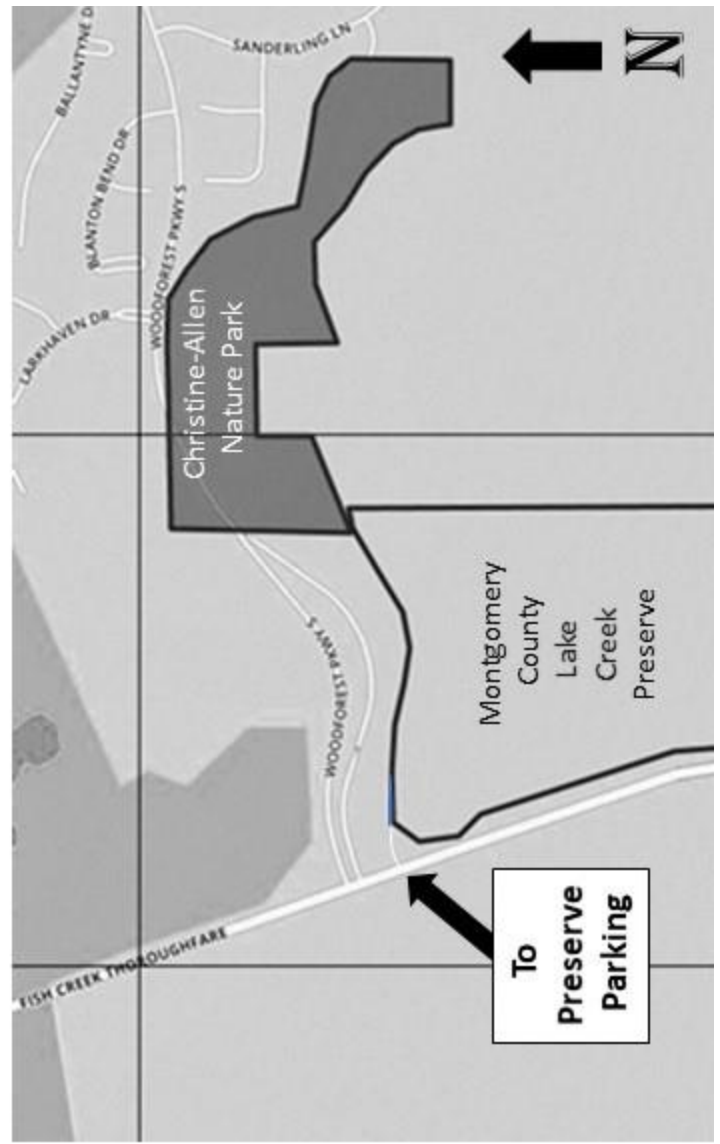
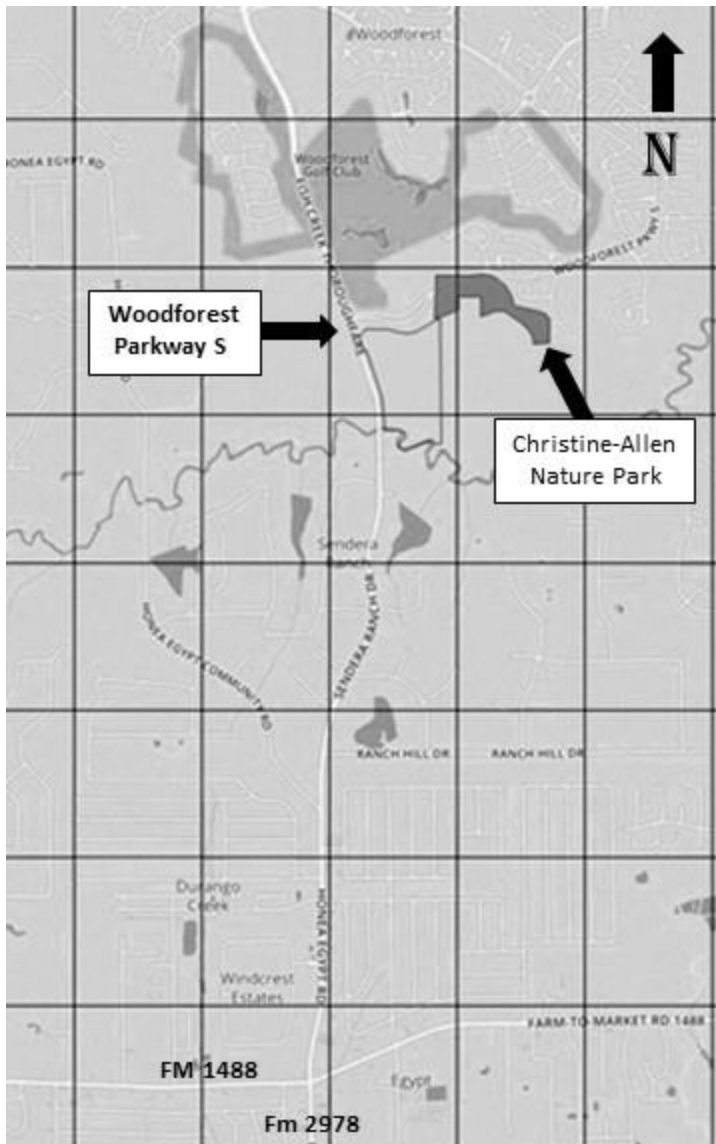

**FROM THE SOUTH:** From the intersection of FM1488 and FM 2978 proceed north on Honea-Egypt road to the bridge across Lake Creek. The first turn to the right leads to the parking area for the Lake Creek Preserve. The second turn at the light is the Woodforest Parkway which leads to the park on the right. There are parking places in the park and along both sides of the Parkway. Alternately, if it isn't too wet you can access the park from the NE corner of the preserve ( there is a bridge across the detention basin connecting to the park).

**FROM THE NORTH:** Continue south on Fish Creek Thoroughfare past the entrance to the Woodforest Golf Club. Turn left onto Woodforest Parkway South. The park will be on your right and parking will be available in the park and along Woodforest Parkway. Watch the Traffic if you park along the parkway.